



Shower enclosure, art. B4910LUCTRS01/DX

The shower accessories have being designed exclusively by **samo**

*Spacious shower enclosure, featured by dedicated access area and only fixed panels.
The access area to the shower is open, doorless.*



- **Steel finishing profiles:**
LUC brilliant

- **Tempered glass finishing panels:**
TR transparent

- TG** transparent Grey

- **Shower tray finishing:**

- L01** Methacrylate white

- S01** Stonecril white

Easy version

Article	Height [cm]	Opening [cm]	Maximum Overall	Volume [dm ³]	Weight [kg]	Panels finishing	L01	S01
B4900LUC	210	45	142x92	1056	113	TR TG		

The version includes: shower head, hand shower, mechanical mixer with switch and "stylo" handle.
In the order specify if right hand DX version or left hand SX version.

Enjoy version

Article	Height [cm]	Opening [cm]	Maximum Overall	Volume [dm ³]	Weight [kg]	Panels finishing	L01	S01
B4910LUC	210	45	142x92	1056	121	TR TG		

The version includes: shower head, hand shower, 4 drojet, thermostatic mixer with a 3-functions switch.
In the order specify if right hand DX version or left hand SX version.

Shower curtains optional

Article	Description	01	04	08	23
YA4890T	Silk Shantung curtains				

Available in: **01 White Sincero** - **04 Green Vivace** - **08 Sand Audace** - **23 Violet Spavaldo**, (see pages on page 52).

Shower tray optional

Article	Description	Height [cm]	Maximum Overall [cm]	L01
F4900 *	Inspection strip for shower tray	15,5	142x92	

*Can be combined with methacrylate trays only.

Wooden shower insert optional

Article	Description	Shower tray measures [cm]	Inside Measures [cm]	CL	WE	FG
KP4900	Wooden shower insert	92x142	84x66			

Available in colour finishings: **cherrywood finish=CL** / **wengé finish =WE** / **beech finish =FG**.

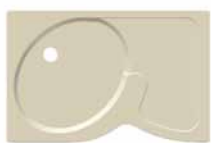

DX (right version)

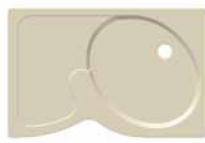

SX (left version)

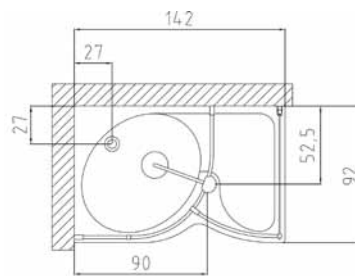

Shower tray NOT reversible, indicate version DX (right) or SX (left)



Installation is available upon request, please refer to the closest Service Centre

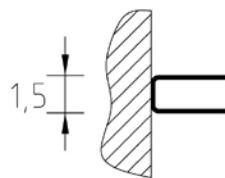

Wall profiles dimensions



Wooden inserts.
WE = wengé coloration
CL = cherrywood coloration
FG = beech coloration

Packaging is composed of n° boxes: **4**

Sector	Delivery Ex Works
Sector A	1-2 Weeks
Sector B	3 Weeks
Sector C	4-5 Weeks
Sector N	bespoke and new products



Shower enclosure, art. B4950ULUTR
Shower tray, art. D4950S01DX

Spacious shower enclosure, featured by dedicated access area and only fixed panels. The access area to the shower is open, doorless. Possible installation also without shower tray: a lower gasket allows to isolate the glass panel from the supporting surface.

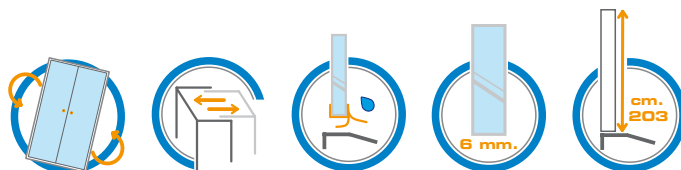

• **Aluminium finishing profiles:**

- L01** white
- ULU** brilliant chrome

• **Tempered glass finishing panels:**

- TR** transparent
- TG** transparent Grey

Corner version with lateral panel

Article	Height [cm]	Opening [cm]	Volume [dm ³]	Weight [kg]	Panels finishing	L01	ULU
B4950	203	47	700	74	TR TG		

Shower enclosure made from a rounded panel, a flat panel and stabilising bar.
Suitable for optional flat shower tray 142x92 cm.

Niche version without lateral panel

Article	Height [cm]	Opening [cm]	Volume [dm ³]	Weight [kg]	Panels finishing	L01	ULU
B4951	203	47	603	40	TR TG		

Shower enclosure made from a single bent panel and stabilising bar. Suitable for optional flat shower tray 142x92 cm.
If installed without flat shower tray it is suggested to leave at least 40 cm. of external opening for the passage.

Shower curtains optional

Article	Description	01	04	08	23
YA4890T	Silk Shantung curtains				

Available in: **01 White Sincero - 04 Green Vivace - 08 Sand Audace - 23 Violet Spavaldo**, (see pages on page 52).

Shower tray optional

Article	Description	Height [cm]	Maximum Overall [cm]	L01	S01
D4950	Methacrylate - Stonecrist shower tray	//	142x92		
F4900 *	Inspection strip for shower tray	15,5	142x92		

* Can be combined with methacrylate trays only.

Wooden shower insert optional

Article	Description	Shower tray measures [cm]	Inside Measures [cm]	CL	WE	FG
KP4900	Wooden shower insert	92x142	84x66			

Available in colour finishings: **cherrywood finish=CL / wengé finish =WE / beech finish =FG.**



Niche version, art. B4951ULUTR



Wooden inserts.
WE = wengé coloration
CL = cherrywood coloration
FG = beech coloration

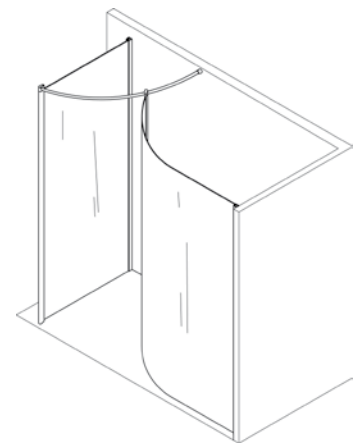

ASSISTANCE SERVICE
samo

Installation is available upon request, please refer to the closest Service Centre

Packaging is composed of n° boxes: **1/2**

Sector	Delivery Ex Works
Sector A	1-2 Weeks
Sector B	3 Weeks
Sector C	4-5 Weeks
Sector N	bespoke and new products

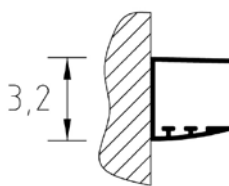

Wall profiles dimensions

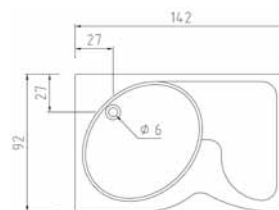

DX (right version)

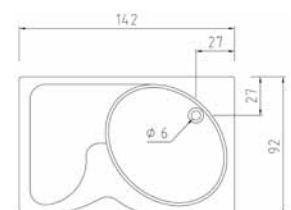

SX (left version)

Shower tray NOT reversible, indicate version DX (right) or SX (left).